

# SGP 5330



## High-Speed Bundling

Up to 45 bundles per minute to maximize production capacity

## IOT Ready

Multiple interface options available to remotely monitor, diagnose and resolve machine performance

## Fully Electric Design

No pneumatics needed for hold down device and other machine options

## Smart Interface

Touchscreen HMI with up to 5000 recipes for logging and export capabilities and advanced user management



# SGP 5330

## Automatic strapping machine



The SGP 5330 automatic strapping machine provides high-speed bundling capabilities for packaging lines in various industries and applications. The SGP 5330 is designed to be integrated in conveyor lines and works fully automatic. The SGP 5330 simplifies maintenance requirements with easy, no-tools access to strap path and robust strap arch. Stored bundle recipes accessible in the smart touchscreen HIM minimize production interruption due to product change. The incoming bundle is detected, positioned and strapped according to set parameters on intuitive HMI panel.

### Standard Equipment

- Included strap patterns
  - front and parallel strapping
  - double strapping
  - triple, quadruple and multiple strapping
  - centered strapping
  - back strapping
- Two swivel castors with brakes
- Two fixed castors for easy moving
- Strap loop ejection for cycles without product
- Cycle counter
- Electrical power cable, 5 m
- Energy saving: Automatic conveyor stop.
- Interface
  - 24 pin Harting connector
  - 2x 40 pin (optional)
  - Ethernet, EtherCAT, ProfiNET, ProfiBUS (Optional)
- Signal lamp 3 colors

### Options

- Dual coils with automatic strap change
- Hold-down device
- Bundle stops
- Belts instead of rollers
- see options list for complete overview

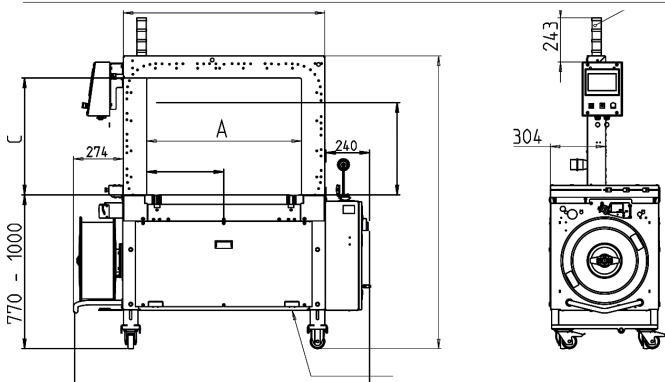

### Machine Dimensions

Seal method	Heat weld sealing
Electrical supply	380-520 V, 3AC, 47-63 Hz 100-240 V, 1AC, 47-63 Hz (option)
Room temperature	5-45 °C (41-113 °F)
Cycles per minute up to* (without conveyor)	65/min.
Conveyor speed, stepless	6-60 m/min (6,5-65 yd/min)
Machine weight	300 kg (660 lbs)
Color	Black RAL 9005, slate grey RAL 7015
Arch dimension A x C	650 x 540 mm (26 x 20") 850 x 640 mm (33 x 26") 850 x 840 mm (33 x 33") other on request
Packages	
Width x height min.	100 x 10 mm (4 x 0,4")
Width x height max.	Arch dimensions minus 50 mm (./.2")
Length min.	140 mm (8")
Weight max.	30 kg (77 lbs) belts / 50 kg (110 lbs) roller
Plastic Strap (PP)	
Strap width	5 mm (1/4") 9 mm (3/8") 12 mm (1/2")
Strap thickness	0,40-0,65 mm (0,015-0,024")
Strap coil, Ø inside/outside	200/430 mm (8/17")
Strap tension 5-12 mm (1/4 / 1/2")	450 N

The polypropylene straps used for the respective applications must correspond with the strap specifications recommended!

\*Performance: Depends on arch and package dimensions, conveyor speed, package distances and strap tension.

